

GAT Holder 60xx

Holder for GANTNER Terminals



Application

The GAT Holder range is used to mount GANTNER access, time and information terminals of the series 6100, 6500, 6600, 6800, ST 280, ST 290, ST x80 and ST x90. The holders can be used in combination depending on the intended application of the terminal.

Functional description

Terminals of the 6500 and 6800 series are mounted using the GAT Holder 6050 or GAT Holder 6060. In comparison to the GAT Holder 6050, the GAT Holder 6060 provides additional protection against water falling from overhead. These holders have an adapter with an inside diameter of 30 mm and can be combined with the GAT Holder 6010 L, GAT Holder 6020, or GAT Holder 6030.

The GAT Holder 6040 and 6041 is provided for mounting terminals of the GAT STx80 / x90 series and the GAT 6100 series. The GAT Holder 6040 includes a flange piece for mounting a terminal onto a GAT Holder 6010 L, 6020, or 6030. The GAT Holder 6041 is designed for installing the terminal onto a flat surface such as a wall.

The GAT Holder 6010 L, 6020, and 6030 differ in length and can be mounted onto a turnstile (GAT Holder 6010 L, GAT Holder 6030) or directly to the floor (GAT Holder 6020). The GAT Holder 6030 is suitable for mounting onto a turnstile such as the GAT TPB Turnstile K S03 Typ 2. Using the GAT Holder 6070, the GAT 6100 series terminals (e.g. GAT Access 6100 with fingerprint reader) can be mounted onto a turnstile or desk. This combination forms an ideal fingerprint reading station suitable for recording and verifying fingerprints at a reception desk.

Two holders are available for the GAT Access 6600. The GAT Holder 6080 allows the GAT Access 6600 to stand freely on a desk or table and the GAT Holder 6090 is used to wall mount the GAT Access 6600.

Highlights

- Concealed cable inlet to the terminal via holder tube
- Various combinations available for different applications
- Holder for mounting the 6100 series terminals onto a turnstile

GAT Holder 6050

GAT Holder 6060

GAT Holder 6070

GAT Holder 6080

GAT Holder 6090

Order information

Description	Part No.
GAT Holder 6010 L Mounting tube for the GAT Holder 6040/6050/6060, semi-matte stainless steel, Ø 30 mm (1.18"), length 19 cm (0.75")	766890
GAT Holder 6020 Mounting tube for the GAT Holder 6040/6050/6060, semi-matte stainless steel, Ø 60 mm (2.36"), length 121 cm (47.64")	767083
GAT Holder 6030 Mounting tube for the GAT Holder 6040/6050/6060, semi-matte stainless steel, Ø 30 mm (1.18"), length 30.9 cm (1.22")	769994
GAT Holder 6040 Holder for the GAT SA 30x and GAT SR30x/31x devices and the 6100 series terminals, with Ø 30 mm (1.18") flange for the GAT Holder 6010 L/6020/6030	119326
GAT Holder 6041 Holder for the GAT SA 30x and GAT SR30x/31x devices and the 6100 series terminals, for wall mounting with 60 mm (2.36") drill spacing	119427
GAT Holder 6050 Mounting frame for 6500, 6800, ST x80, and ST x90 series terminals, with Ø 30 mm (1.18") flange	654179
GAT Holder 6060 Weather protection housing for 6500, 6800, ST x80, and ST x90 series terminals, semi-matte stainless steel	767285
GAT Holder 6070 Holder for mounting 6100 series terminals onto a turnstile or desk, semi-matte stainless steel	636936
GAT Holder 6080 Holder to stand GAT Access 6600 terminals on a desk or table, semi-matte stainless steel	430621
GAT Holder 6090 Holder for wall mounting GAT Access 6600 terminals, semi-matte stainless steel	640422

Technical data

Dimensions:

GAT Holder 6010 L (Ø x length):	30 x 190 mm (1.18 x 7.48")
GAT Holder 6020 (Ø x length):	60.7 / 30 x 1210 mm (2.39 / 1.18 x 47.64")
GAT Holder 6030 (Ø x length):	30 x 309 mm (1.18 x 12.17")
GAT Holder 6040 (Ø x length):	81.2 x 90.2 x 55.8 mm (3.2 x 3.55 x 2.2")
GAT Holder 6041 (Ø x length):	81.2 x 90.2 x 3 mm (3.2 x 3.55 x 0.12")
GAT Holder 6050 (w x h x d):	219 x 243 x 100 mm (8.62 x 9.57 x 3.94")
GAT Holder 6060 (w x h x d):	217 x 230.6 x 159 mm (8.54 x 9.08 x 6.26")
GAT Holder 6070 (l x w x h):	220.3 x 96 x 190 mm (8.67 x 3.78 x 7.48")
GAT Holder 6080 (Ø x length):	30 x 270 mm (1.18 x 10.63")
GAT Holder 6090 (Ø x length):	30 x 260 mm (1.18 x 10.24")

Housing:

GAT Holder 6010 L:	Stainless steel CNS 1.4301
GAT Holder 6020:	Stainless steel CNS 1.4301
GAT Holder 6030:	Stainless steel CNS 1.4301
GAT Holder 6040:	Stainless steel CNS 1.4301
GAT Holder 6041:	Stainless steel CNS 1.4301
GAT Holder 6050:	Plastic (PUR)
GAT Holder 6060:	Stainless steel CNS 1.4301
GAT Holder 6070:	Stainless steel CNS 1.4301
GAT Holder 6080:	Stainless steel CNS 1.4301
GAT Holder 6090:	Stainless steel CNS 1.4301

Dimensions of GAT Holder 6010 L

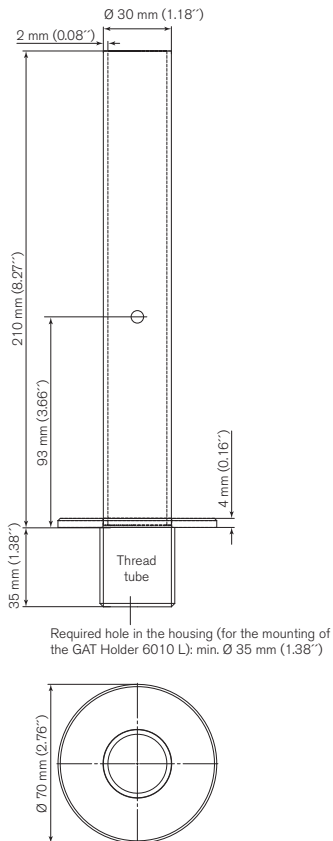

Dimensions of GAT Holder 6020

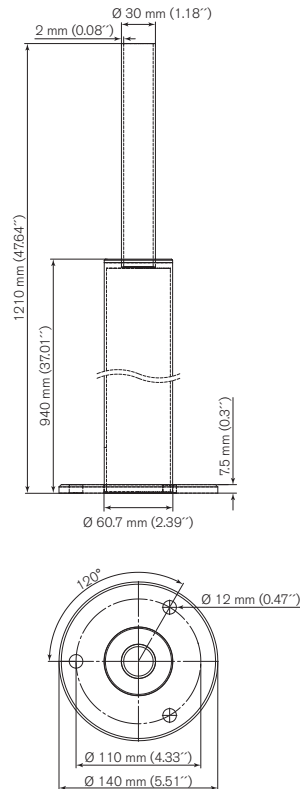

Dimensions of GAT Holder 6030

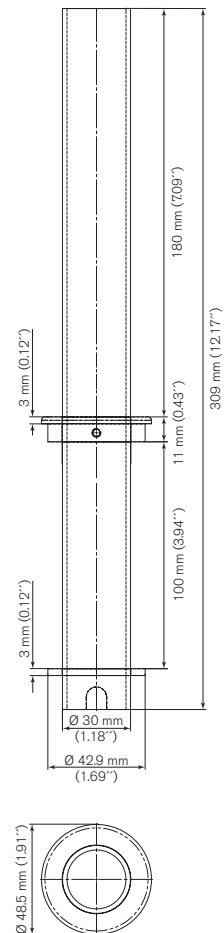

Dimensions of GAT Holder 6040

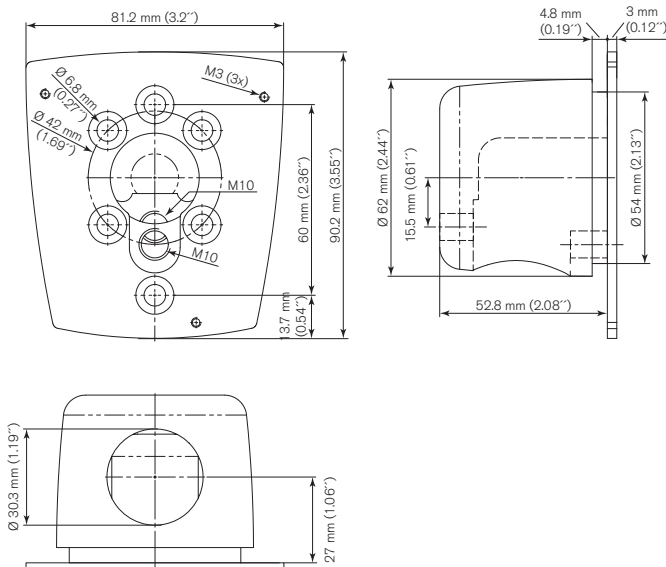

Dimensions of GAT Holder 6041

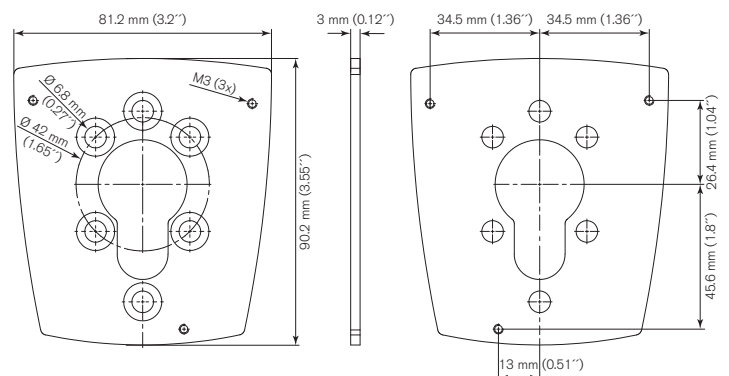

Dimensions of GAT Holder 6050

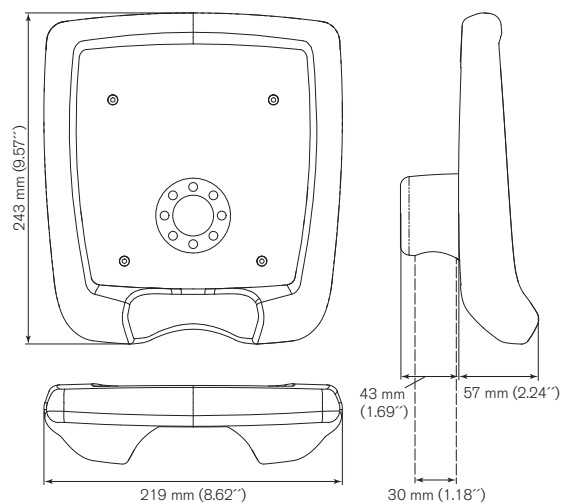

Dimensions of GAT Holder 6060

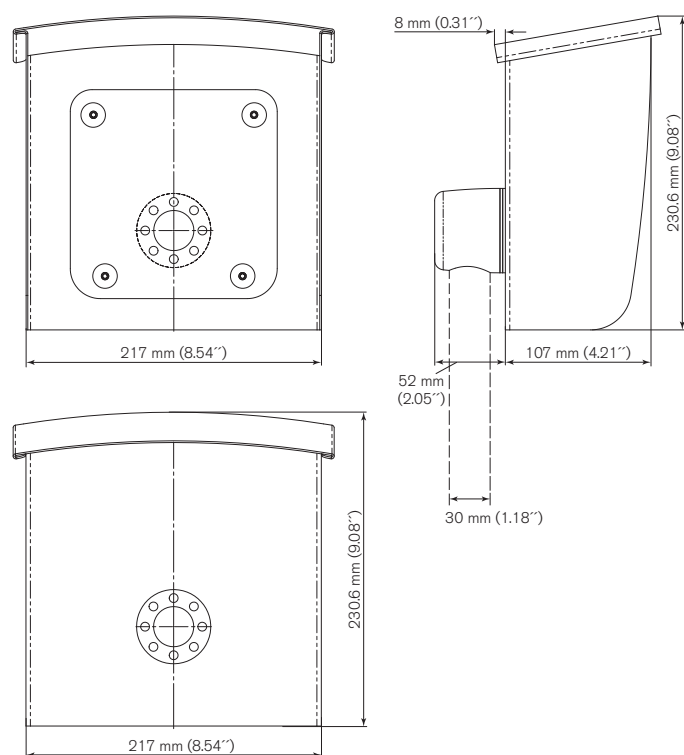

Dimensions of GAT Holder 6080

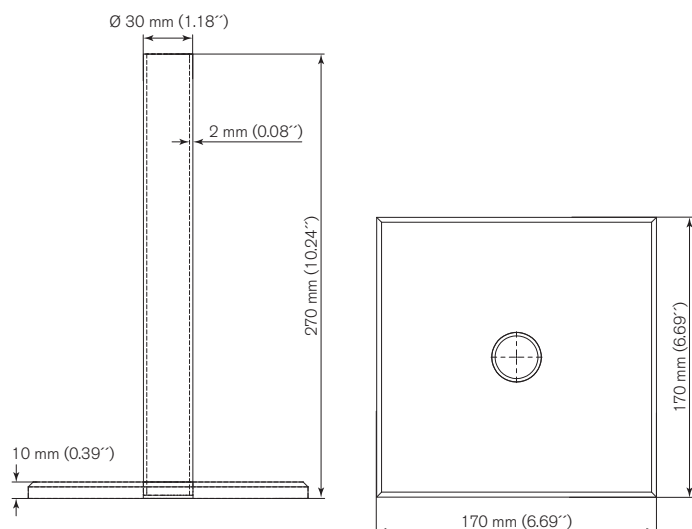

Dimensions of GAT Holder 6070

- 1 Opening for connection cable from turnstile or desk
- 2 Mounting holes to install the holder onto a desk or turnstile
- 3 Opening for connection cables to the terminal
- 4 Fastening holes for terminal

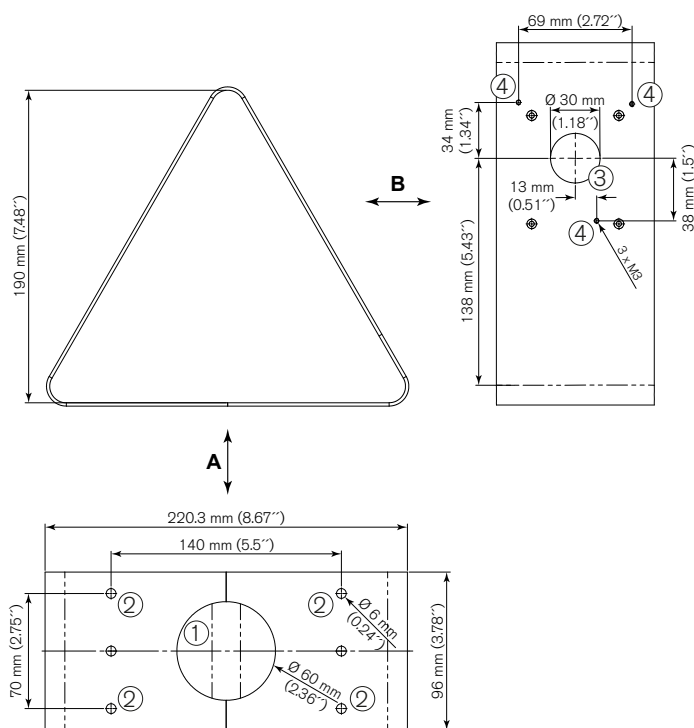

Dimensions of GAT Holder 6090

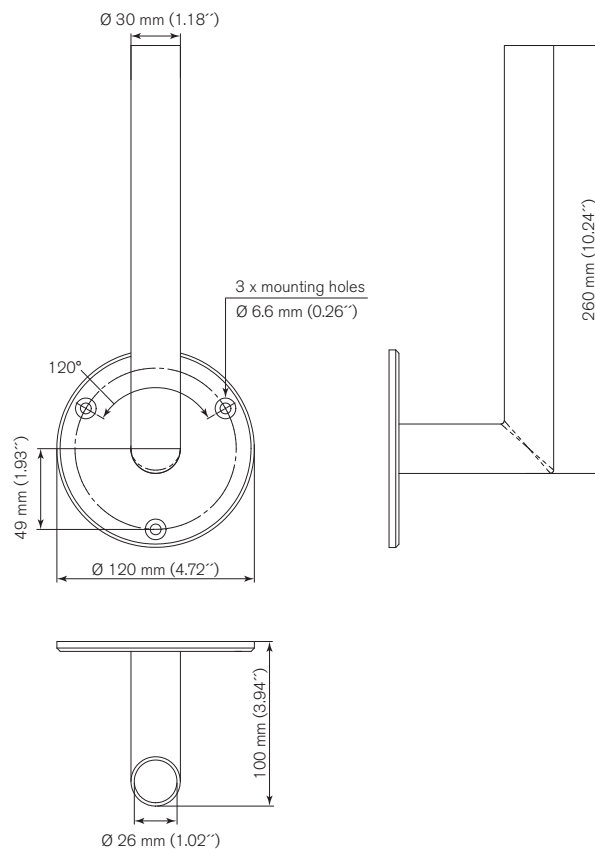

Typical application

Wall mounted GAT 6500/6800

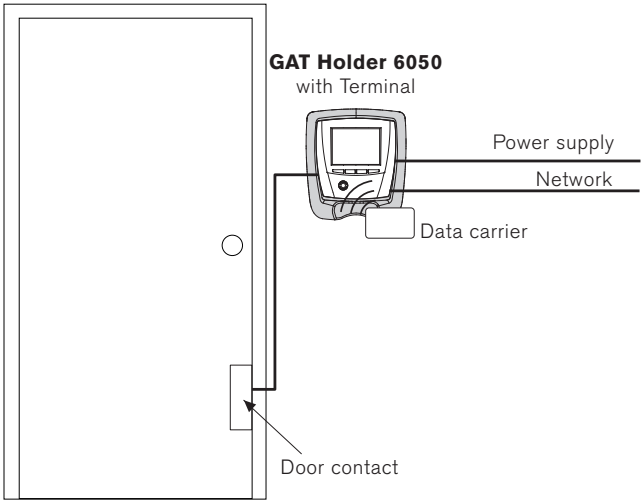

Turnstile mounted GAT Access 6100

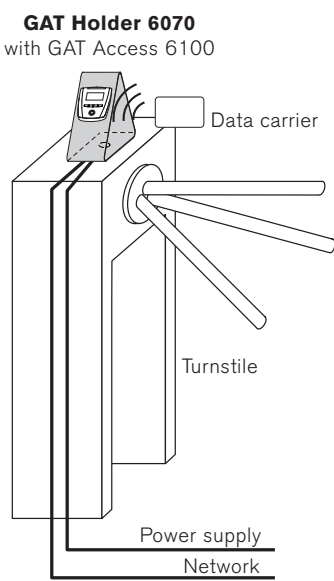

Turnstile mounted GAT 6500/6800

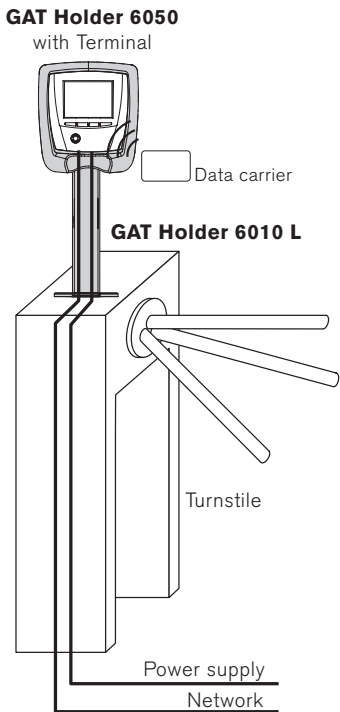

Wall mounted GAT Access 6600

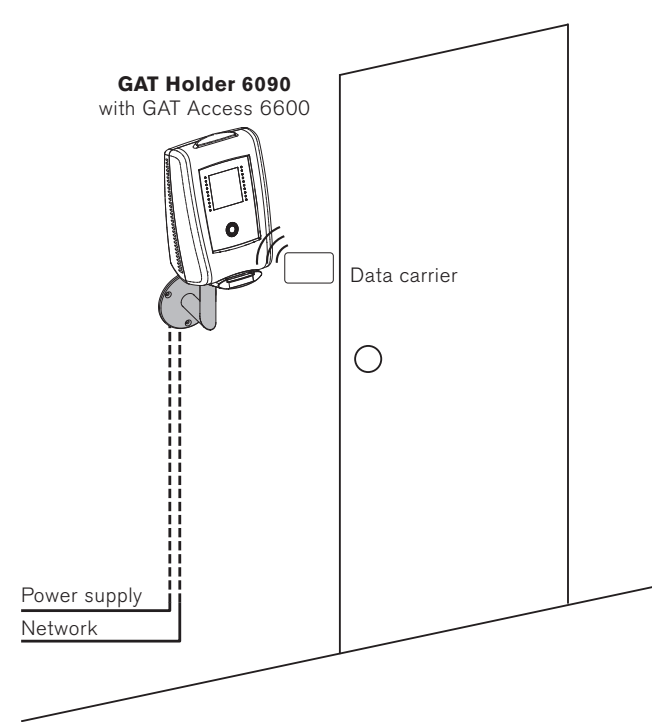

Floor mounted GAT 6500/6800

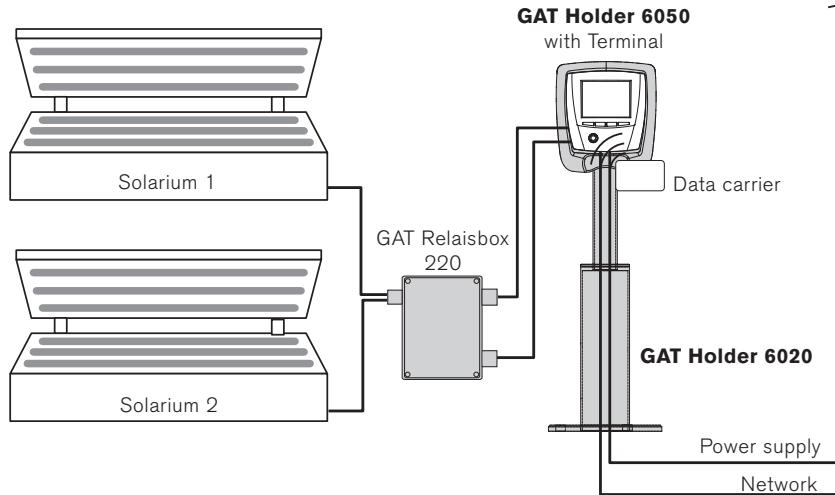

Installation instructions

Different combinations of GAT Holder 60xx are available for installation. The mounting frames provide support for the terminal and can be mounted directly or combined with holder tubes. The following information shows which holders can be installed with the terminals:

- GAT Holder 6040/6041: GAT Access 6100, GAT Info 6100, GAT Time 6100, GAT SR x0x/x1x, GAT SA x0x/x1x
- GAT Holder 6050/6060: GAT Access 6500, GAT Info 6800, GAT Time 680x
- GAT Holder 6070: GAT Access 6100 (with or without fingerprint GAT FR 050), GAT Info 6100, GAT Time 6100, GAT SR x0x/x1x, GAT SA x0x/x1x
- GAT Holder 6080/6090: GAT Access 6600

Mounting of the GAT Holder 6040

1. First ensure that the adapter (1) at the back of the GAT Holder 6040 is attached correctly (opening for the holder tube points down).
2. Feed the connection cables (6) through the holder tube (8) and the adapter (1). Attach the holder tube (8) to the adapter (1) and secure using M10 screws (9).
3. Feed the connection cables (6) through the mounting frame (2) and attach the mounting frame to the adapter using 4 screws (3).
4. Feed the connection cables (6) through the opening (7) on the rear housing part and attach the rear housing part (4) to the mounting frame (2) using 3 screws (5).
5. Connect the cables (6) to the rear housing part (4). See the applicable terminal documentation for more information.
6. To put the terminal into operation, attach the terminal to the mounting frame.

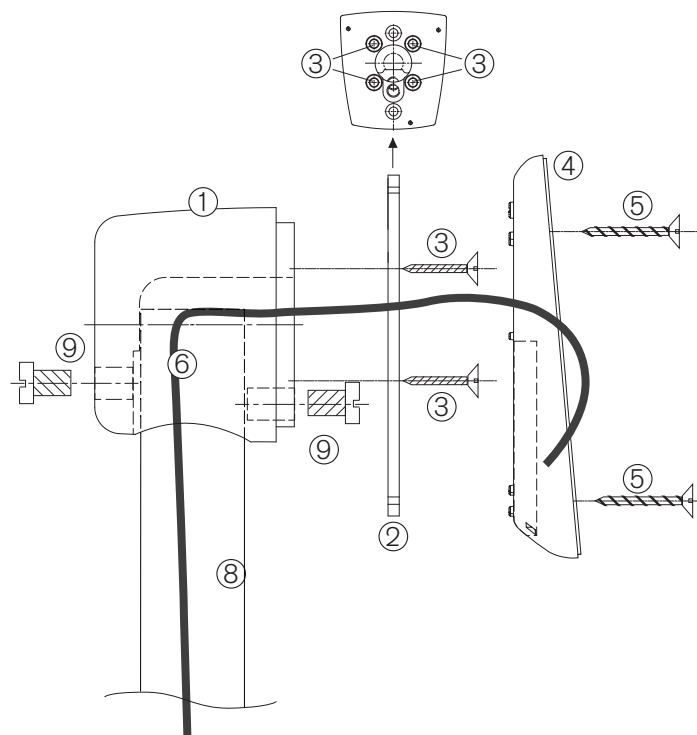

Mounting of the GAT Holder 6041

The GAT Holder 6041 is used to mount the terminal onto a flat surface (e.g. wall). The installation process is similar to the GAT Holder 6040. The adapter is not included.

1. Feed the connection cables (6) through the back box (10) and mounting frame (2).
2. Attach the mounting frame to the wall or back box (2) using the required screws (3).
3. Feed the connection cables (6) through the opening (7) on the rear housing part.
4. Attach the rear housing part (4) to the mounting frame (2) using 3 screws (5).
5. Connect the cables (6) to the rear housing part (4). See the applicable terminal documentation for more information.
6. To put the terminal into operation, attach the terminal to the mounting frame.

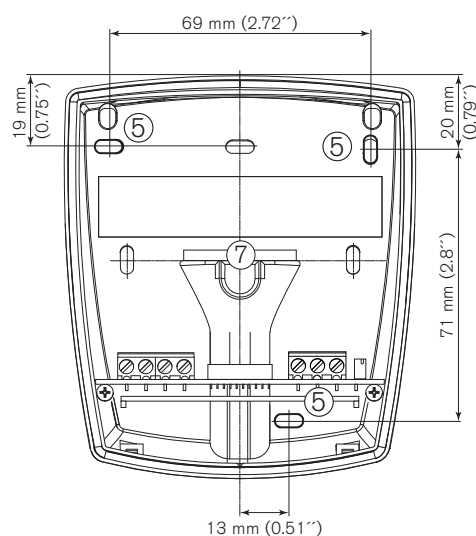
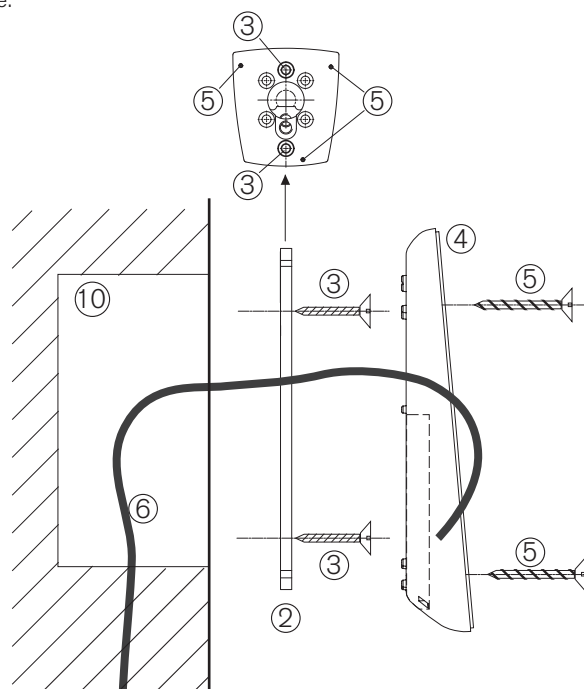

Mounting of the GAT Holder 6050

1. Ensure that the adapter (1) at the back of the GAT Holder 6050 (3) is attached in the correct orientation. Upon delivery, the adapter (1) is attached so that the holder tube (4) can be inserted from below. If required, the adapter (1) can be detached via the 4 screws (2) and reattached in a different orientation.
2. Insert the holder tube (4) into the adapter (1) and tighten the 4 screws (2) on both sides of the adapter.
3. Attach the mounting frame of the terminal (5) to the GAT Holder 6050 (3) and tighten the 4 screws (6).
4. Feed the connection cables (7) through the holder tube (4) and adapter (1) then connect to the mounting frame of the terminal (5).
5. To activate the terminal, attach the terminal to the mounting frame (5).

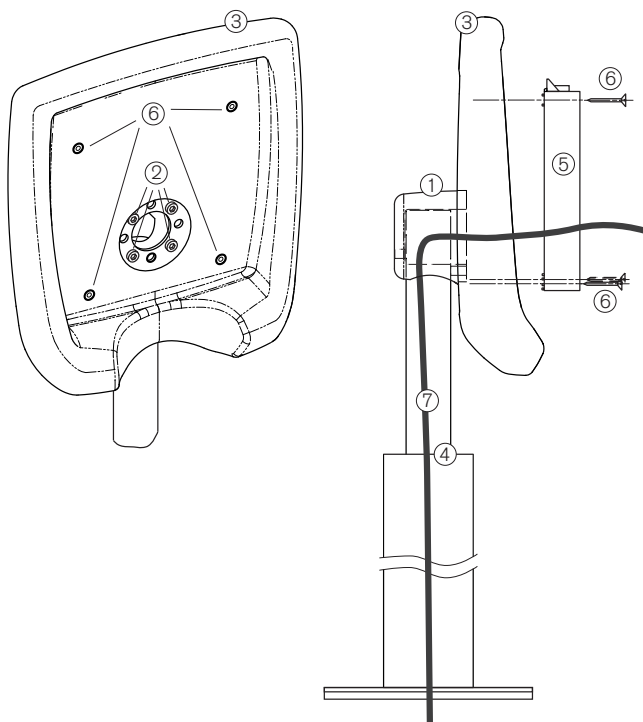

Mounting of the GAT Holder 6060

For installations where the terminal is exposed to the weather, use the GAT Holder 6060 weather protection housing.

NOTE! See the GAT Holder 6050 mounting instructions for information on attaching the mounting frame and terminal to the weather housing.

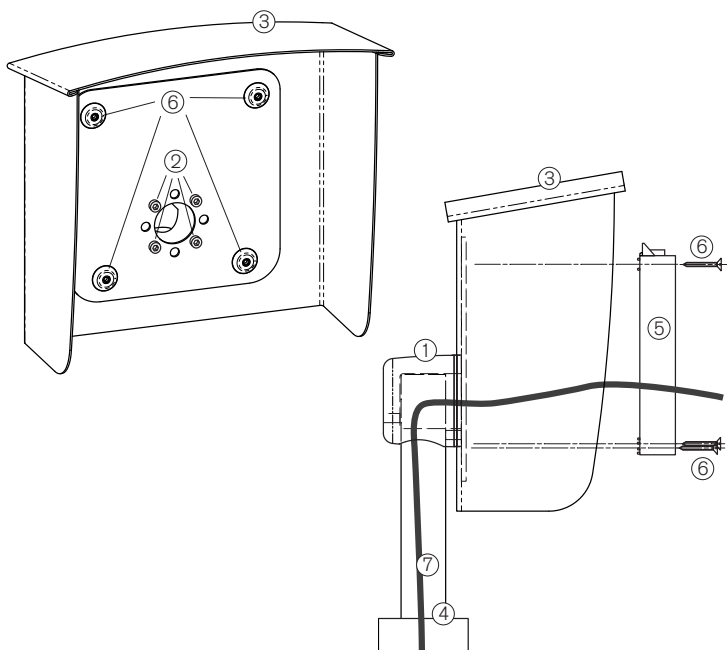

Mounting of the GAT Holder 6070

1. Feed the connection cables through the openings on the base and front side of the holder (1).
2. Attach the GAT Holder 6070 to the turnstile using 4 screws (2).
3. Attach the two side parts using 3 screws (3).
4. Attach the rear part of the terminal (e.g. GAT Access 6100) to the holder using the supplied washers and fillister head screws (M3x16).
5. Connect the cables to the rear part of the terminal. See the applicable terminal documentation for more information.
6. Attach the front part of the terminal according to the instructions provided in the documentation.

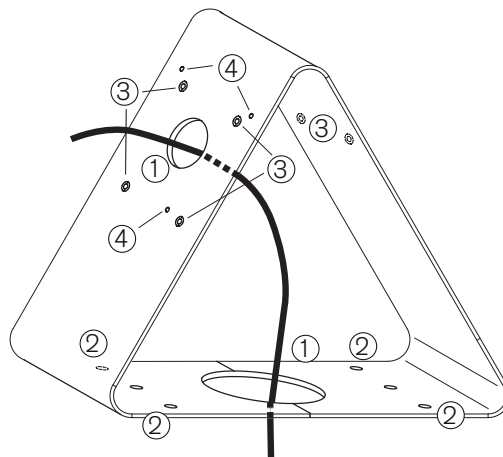

NOTE! The GAT FR 055 fingerprint reader can also be installed. The mounting process is similar but with the fingerprint reader attached to the terminal. See the GAT FR 055 documentation for details.

Mounting of the GAT Holder 6080 / 6090

NOTE! For mounting the GAT Holder 6080, ignore steps 1 and 6.

1. Mark out and drill 3 mounting holes (2) for the GAT Holder 6090 (1). The screws and wall plugs are included with the GAT Holder 6090.
2. Feed the connection cables (6) through the holder tube (1).
3. Insert the GAT Access 6600 (3) onto the holder (1) until the stop (4) is reached.
4. Tighten the two holder clamps so that the GAT Access 6600 is secure.
5. Connect the cables to the GAT Access 6600 and close the housing. See the GAT Access 6600 documentation for more information.
6. Attach the GAT Holder 6090 (1) to the wall using the 3 screws (5).

